

SAND VOLLEYBALL COURTS

Two sand volleyball courts are located at Campbell Recreation Area, a 32-acre park that also includes three adult softball fields (rentable), a basketball court, three tennis courts, playground areas, open space for soccer or football, a shelter (rentable) and a gazebo.

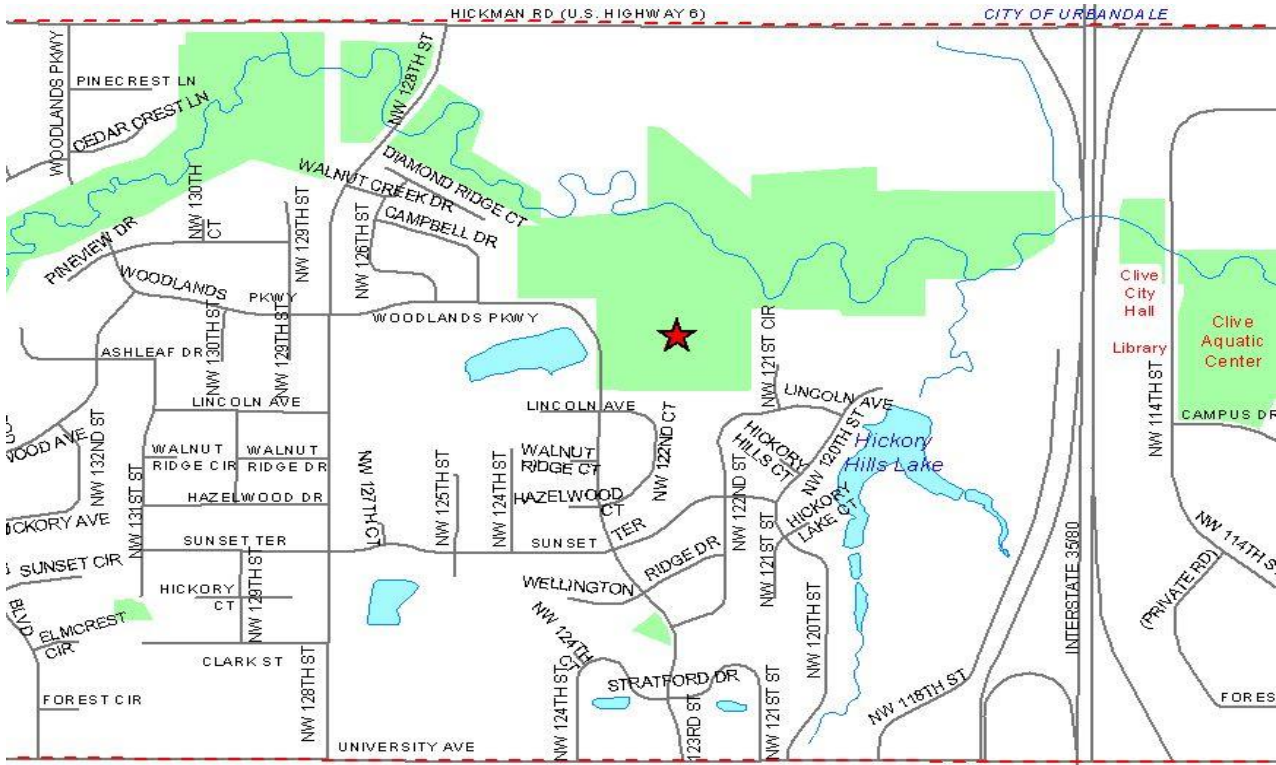

The renter shall be responsible for any and all damage to the facility occurring during the term of the rental.

That renter shall indemnify and hold harmless the City of Clive, it's officers, agents and employees, from and against any and all loss, liability or damage arising out of renter's use of the facility, including all costs, expenses and attorney fees incurred in defending any claims arising out of the use thereof, except to the extent that the injuries or damages resulting in such losses or liabilities arise by reason of the negligence of the City of Clive, their successors or assignees.

That renter takes the facility as renter finds it and voluntarily assumes all risk of loss, damage, or injury (including death), that may be sustained by renter or any property of any of the undersigned while in, on or upon said facility.

Renter shall fully comply with all applicable state laws, City ordinances and rules applicable to the use of the facility. Smoking is prohibited on playgrounds and in park shelters located on City property, including adjacent areas within 50 feet of playgrounds and park shelters (in compliance with the Iowa Smokefree Air Act).

The City of Clive reserves the right to refuse the rental of the facilities.

THIS RESERVATION IS NOT CONFIRMED UNTIL COMPLETED FORM AND PAYMENT ARE RECEIVED.

Renter's Signature _____ **Date** _____

Payment: Cash Check # _____ **Credit Card:** Visa MasterCard Discover

Name on card _____ **Total fees** _____

Card number _____ **Expiration date** _____ **CVV/CVC #** _____

Cardholder signature _____ **Date** _____

For Office Use Only: **Date received** _____ **Received by** _____ **Date given to Parks staff** _____ **Given by** _____